



Features:

- Low-profile and safety chamfer design
- Helps protect overhead door tracks
- Powder-coated safety yellow for high-visibility and lasting durability
- Mounting holes for 1/2" hardware (*anchors not included; must be installed per supplier's recommendation*)
- Sold in pairs; right-hand and left-hand specific mounting
- Custom sizes available upon request
- This product carries a (1) year limited warranty with APS Resource



Available Sizes	1/8" (LD), 3/16" (SD), 1/4" (HD), and 3/8" (XHD)
	48" height
Construction Material	Heavy-duty welded steel

P/N	Height	Strength	Weight
ZG48LD	48"	LITE-DUTY	64 lbs.
ZG48SD	48"	STANDARD-DUTY	88 lbs.
ZG48HD	48"	HEAVY-DUTY	110 lbs.
ZG48XHD	48"	XTRA HEAVY-DUTY	158 lbs.



FRONT VIEW

OVERHEAD VIEW

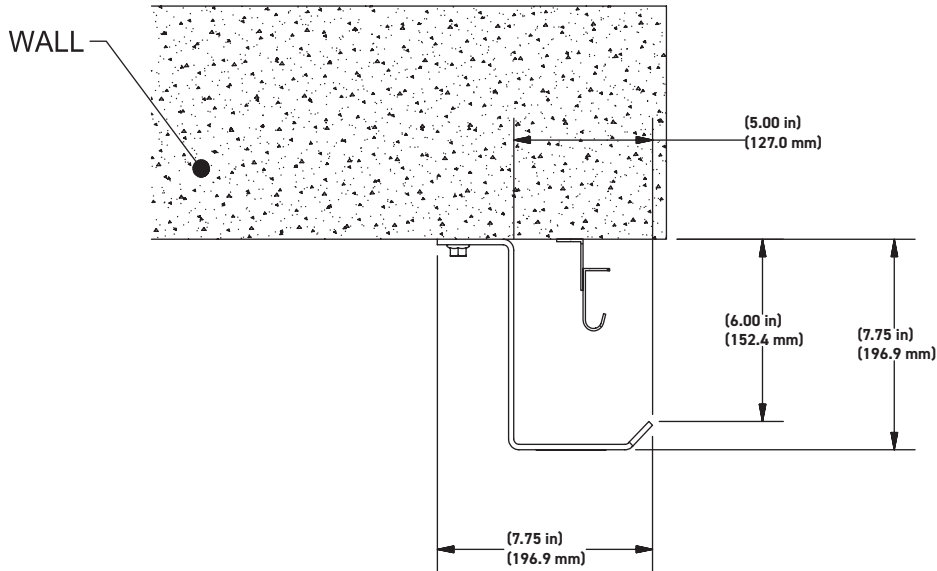
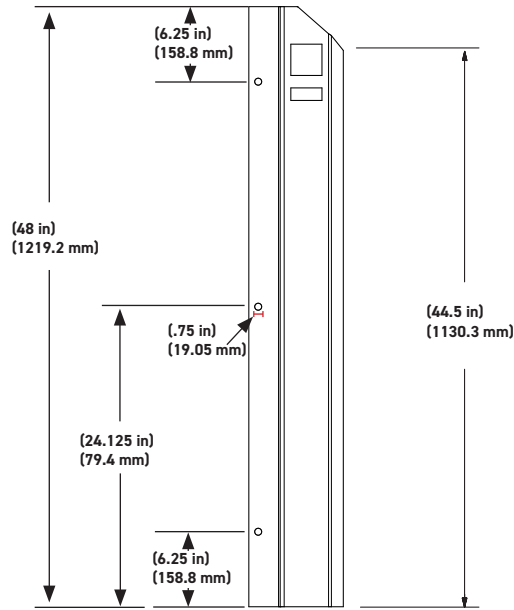

Project Information

Job Name _____

Address _____

General Contractor _____

Distributor _____

Model _____

Quantity _____

Certified for Construction

By _____

Company _____

Address _____

Date _____

Contact us today!

www.apsresource.com
info@apsresource.com

APS Resource reserves the right to change specifications and designs without notice and without incurring obligations. APS products may be the subject of one or more U.S. and/or foreign, issued and/or pending, design and/or utility patents. APS Resource as word and logo are registered trademarks belonging to 4Front Engineered Solutions, Inc. - APS Resource® or other companies controlled by the same organization. All rights reserved.



APS Resource®
Your Aftermarket Solution