

S.W.A.T.™

Secondary Warning Alert Technology

Design Highlights

- Compatible with most restraints that have an alarm or warning state
- Compact design mounts in most locations, limits possibility of damage
- LED status light to indicate receptacle output status
- Flash rate 60 fpm
- Dry location use only
- Compatible with many dock lights (consult owners manual)
- This product carries a (1) year limited warranty with APS Resource



Figure 1: S.W.A.T. device

The S.W.A.T. device is used in conjunction with a vehicle restraint to notify workers that caution should be used at the loading dock. This safety module flashes the positioned dock light when the restraint enters an alarm or warning state.

Technical Specifications

Module Dimensions	6.50" x 3.85" x 1.25"
Circuit Input	2-Wire, 12-120 VAC/DC, 170 mW
	120VAC, 1.5A fused receptacle for dock light
Certifications	ETL certified

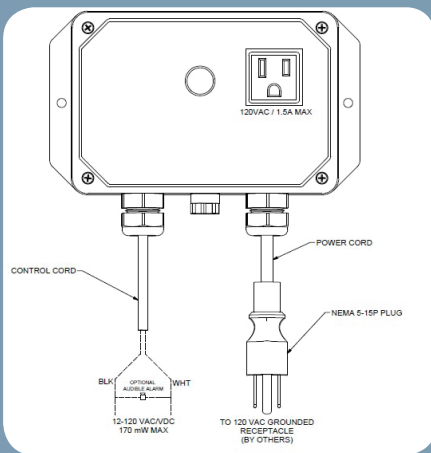

Figure 2: S.W.A.T. wiring schematics

Project Information

Job Name _____

Address _____

General Contractor _____

Distributor _____

Model _____

Quantity _____

Certified for Construction

By _____

Company _____

Address _____

Date _____